

VERNIER CALIPER

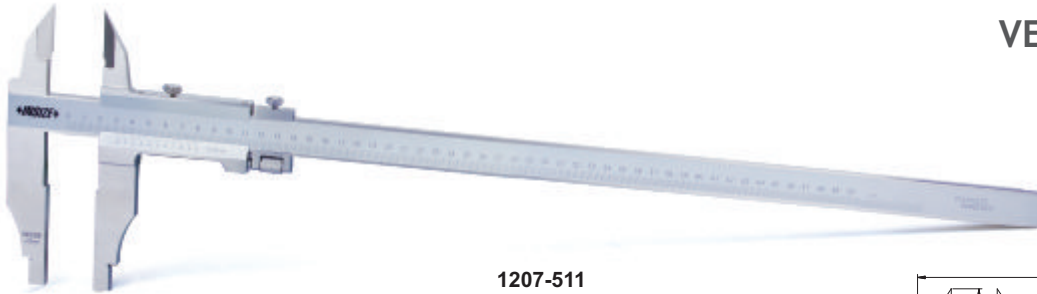

1207-511

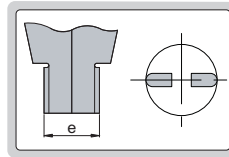

- With fine adjustment
- Made of stainless steel
- Satin chrome plated reading surface

Graduation 0.02mm

| Code | Range | Accuracy | d(mm) |
|-----------|----------|----------|-------|
| 1207-391 | 0-300mm | ±0.05mm | 90 |
| 1207-511 | 0-500mm | ±0.05mm | 100 |
| 1207-521 | 0-500mm | ±0.06mm | 150 |
| 1207-821 | 0-800mm | ±0.07mm | 150 |
| 1207-1021 | 0-1000mm | ±0.08mm | 150 |

Graduation 0.05mm

| Code | Range | Accuracy | d(mm) |
|-----------|----------|----------|-------|
| 1207-393 | 0-300mm | ±0.07mm | 90 |
| 1207-513 | 0-500mm | ±0.07mm | 100 |
| 1207-523 | 0-500mm | ±0.08mm | 150 |
| 1207-823 | 0-800mm | ±0.09mm | 150 |
| 1207-1023 | 0-1000mm | ±0.12mm | 150 |

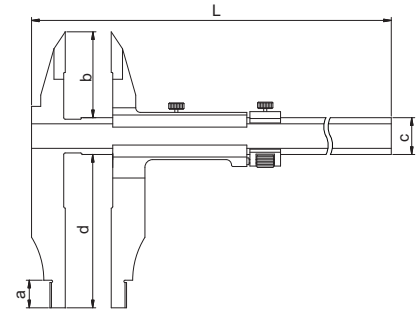

| Range | a | b | c | e | L |
|----------|----|----|----|----|------|
| 0-300mm | 12 | 40 | 20 | 10 | 440 |
| 0-500mm | 18 | 56 | 24 | 20 | 670 |
| 0-800mm | 24 | 67 | 31 | 20 | 930 |
| 0-1000mm | 24 | 67 | 31 | 20 | 1230 |