

# VERNIER CALIPER

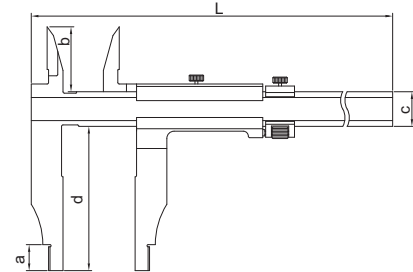

1236-521

- With fine adjustment
- Made of stainless steel
- Satin chrome plated reading surface

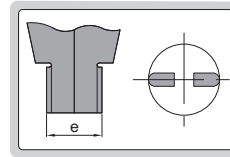

(mm)

## Graduation 0.02mm

Code	Range	Accuracy	d(mm)
1236-391	0-300mm	±0.05mm	90
1236-511	0-500mm	±0.05mm	100
1236-521	0-500mm	±0.06mm	150
1236-611	0-600mm	±0.05mm	100
1236-821	0-800mm	±0.07mm	150
1236-1021	0-1000mm	±0.08mm	150

## Graduation 0.05mm

Code	Range	Accuracy	d(mm)
1236-393	0-300mm	±0.07mm	90
1236-513	0-500mm	±0.07mm	100
1236-523	0-500mm	±0.08mm	150
1236-613	0-600mm	±0.08mm	100
1236-823	0-800mm	±0.09mm	150
1236-1023	0-1000mm	±0.12mm	150

Range	a	b	c	e	L
0-300mm	12	38	20	10	450
0-500mm	18	45	24	20	670
0-600mm	18	45	24	20	770
0-800mm	24	60	31	20	1030
0-1000mm	24	60	31	20	1230